



Features:

200PSI/PN16

Investment Casting

Precise Grinding

Inspection Testing: API598,EN12266

Part List, Material and Dimension

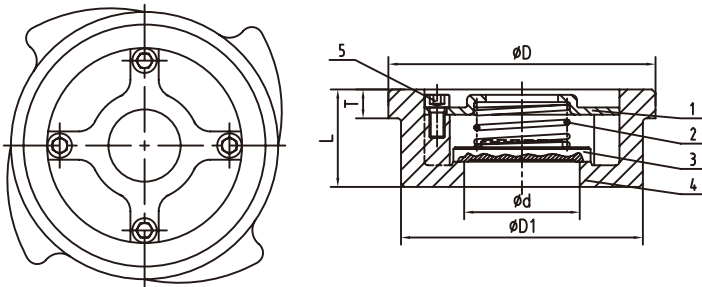

No.	Part Name	Material
1	Bracket	SS304 / SS316
2	Spring	SS304 / SS316
3	Disc	SS304 / SS316
4	Body	CF8 / CF8M
5	Bolt	SS304 / SS316

Size		$\varnothing d$	$\varnothing D1$	$\varnothing D$	L	T
DN15	1/2"	15	37.5	42.5	16	6.5
DN20	3/4"	20	44.5	52.5	19	6.5
DN25	1"	25	54	62	24	7.5
DN32	1-1/4"	32	67	74	27.5	8.5
DN40	1-1/2"	40	78	84	31	9
DN50	2"	50	92	94	39.5	11
DN65	2-1/2"	63	112	115	45.5	11
DN80	3"	78	127	132	49.5	11.5
DN100	4"	98	147	153	59.5	13
DN125	5"	120	182.7	194	90	13
DN150	6"	142	212.6	225	106	15
DN200	8"	185	278.2	290	140	17
DN250	10"	240	332	348	200	20