

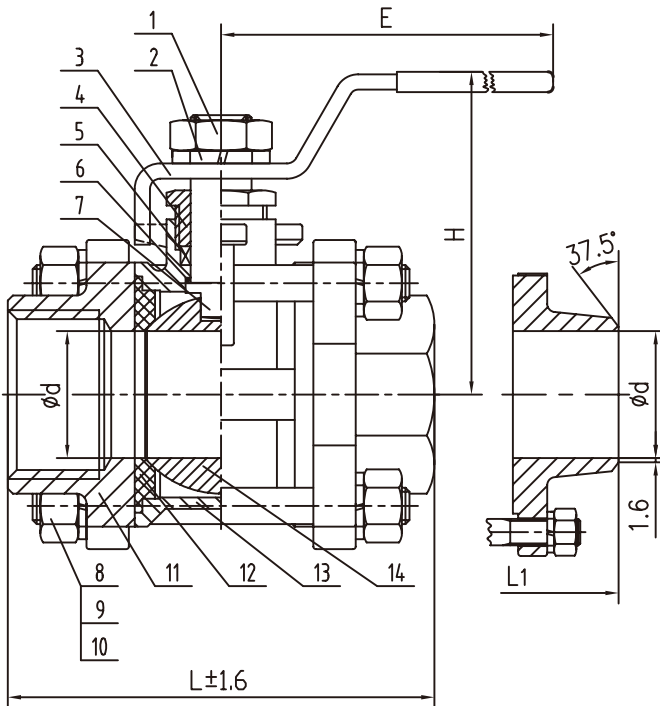

Features:

- 1000PSI / PN63
- Full Port
- Investment Casting
- Blow-out Proof Stem
- Locking Device Handle(Optional)
- Thread: ASME B1.20.1 BS21. DIN2999/259, ISO228-1, JIS B 0203, ISO7/1
- Inspection Testing: API598, EN12266

Part List, Material and Dimension



No.	Part Name	Material
1	Nut	SS304 / SS316
2	Spring Washer	SS304 / SS316
3	Handle	SS201 / SS304 / SS316
4	Gland Nut	SS304 / SS316
5	Packing	PTFE / RPTFE
6	Thrush Washer	PTFE / RPTFE
7	Stem	SS304 / SS316
8	Bolt	SS304 / SS316
9	Spring Washer	SS304 / SS316
10	Nut	SS304 / SS316
11	Cap	WCB / CF8 / CF8M
12	Seat	PTFE / RPTFE
13	Body	WCB / CF8 / CF8M
14	Ball	SS304 / SS316

Size		Ød	H	E	L	L1
DN6	1/4"	12	59	95	67	67
DN10	3/8"	12	59	95	67	67
DN15	1/2"	15	61	115	70 (75)	69
DN20	3/4"	20	67	125	80	79
DN25	1"	25	74	150	90	89
DN32	1-1/4"	32	82	160	110	110
DN40	1-1/2"	38	99	190	119	117
DN50	2"	49	105	200	140	145
DN65	2-1/2"	63	120	265	160 (185)	166
DN80	3"	76	137	310	201	203
DN100	4"	96	157	310	234	241