



Features:

1000PSI / PN63

Full Port

Investment Casting

Blow-out Proof Stem

Locking Device Handle(Optional)

Socket Weld: ASME B16.11

Inspection Testing: API598, EN12266

Part List, Material and Dimension

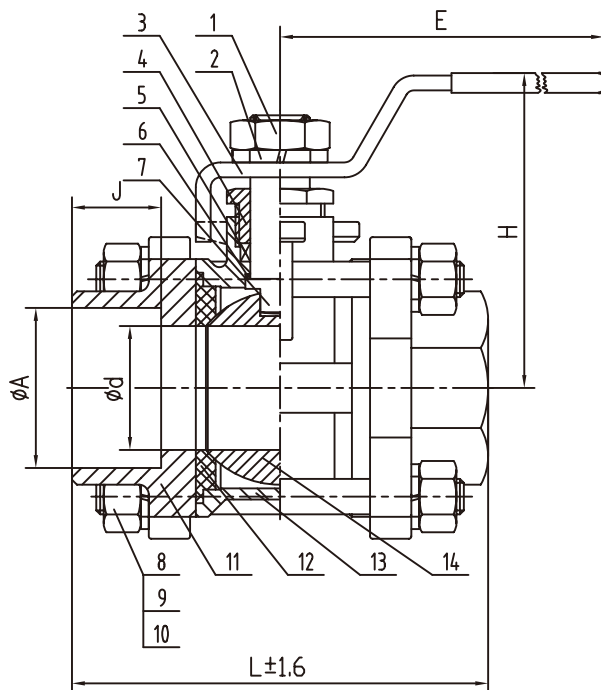

No.	Part Name	Material
1	Nut	SS304 / SS316
2	Spring Washer	SS304 / SS316
3	Handle	SS201 / SS304 / SS316
4	Gland Nut	SS304 / SS316
5	Packing	PTFE / RPTFE
6	Thrush Washer	PTFE / RPTFE
7	Stem	SS304 / SS316
8	Bolt	SS304 / SS316
9	Spring Washer	SS304 / SS316
10	Nut	SS304 / SS316
11	Cap	WCB / CF8 / CF8M
12	Seat	PTFE / RPTFE
13	Body	WCB / CF8 / CF8M
14	Ball	SS304 / SS316

Size		ϕd	ϕD	J	H	E	L
DN6	1/4"	12	14.1	9.5	59	95	67
DN10	3/8"	12	17.5	9.5	59	95	67
DN15	1/2"	15	21.7	10	61	115	70
DN20	3/4"	20	27	13	67	125	79
DN25	1"	25	33.8	13	74	150	88
DN32	1-1/4"	32	42.5	13	82	160	107
DN40	1-1/2"	38	48.6	13	99	190	117
DN50	2"	49	61.1	16	105	200	138
DN65	2-1/2"	63	73.9	16	120	265	160
DN80	3"	76	89.8	16	137	300	201
DN100	4"	96	115.2	19	157	300	234